

Article number: 20057552

Description: E+G Quick-fit coupling (radial displacement)
GN 240.1-M10x1,25-B

Measures

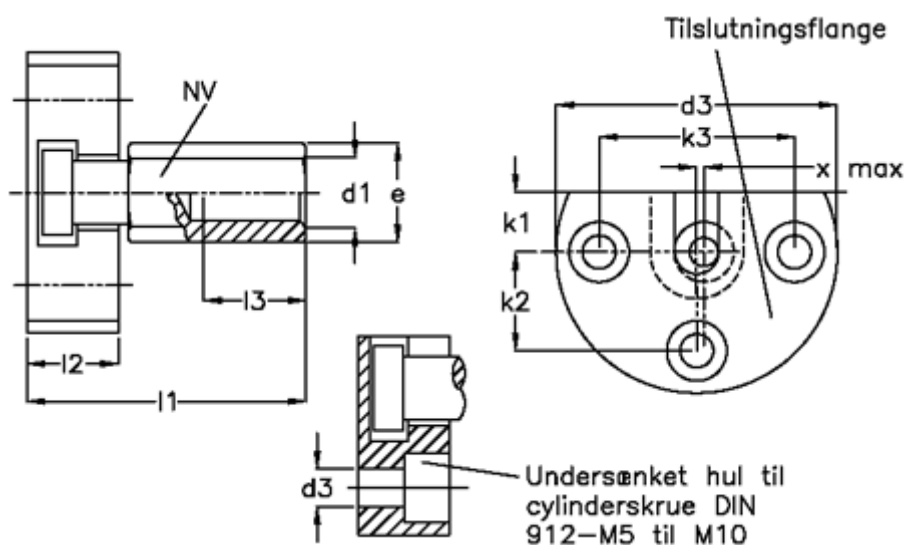

d1 = M 10x1,25	l2	= 16.0
d2 = 50	l3	= 16.0
d3 = 6.5	Max displacement	= 0.7
e = 19.0	Max push-pull strength N	= 6500
k1 = 9.0	NV	= 17
k2 = 17.0		
k3 = 34		
l1 = 43.0		